

WALLS : BELOW WINDOWS + FIREPLACE WALL : RENDER, 100MM DENSE CONCRETE BLOCK, 100MM CAVITY, 50MM CELOTEX CG5000 INSULATION TIGHT AGAINST 100MM CELCON SOLAR INSULATING BLOCK, 13 MM PLASTER. THERMABATE OR SIMILAR CAVITY CLOSERS, SS TIES @ MAX 450 MM CENTRES VERTICALLY AND HORIZONTALLY, U = 0.24. TO STEEL COLUMNS AS DETAIL, U=0.24. HYLOAD OR SIMILAR DPC 150MM ABOVE GROUND LEVEL. BELOW DPC DENSE CONCRETE BLOCK TO CONCRETE FOOTING 900MM BELOW GROUND LEVEL/ OR TO ROCK AS AGREED WITH THE BUILDING INSPECTOR. BEAMS TO BEAM AND BLOCK FLOOR BUILT INTO WALLS AND NEW DWARF WALL [OR EXISTING IF ADEQUATE]; AREA BELOW THIS FLOOR TO BE VENTILATED, WITH AIR BRICKS OR SIMILAR MEANS SET INTO CENTRAL WALL, AND CONCRETE SLAB LAID OVER WHOLE AREA BENEATH. UPVC WINDOWS AND DOORS WITH TRICKLE VENTILATION TO BE MAX U=0.16 CENTRE PANE. CATNIC LINTEL OVER FIREPLACE RECESS.

STEEL FRAME : STEELWORK, CONCRETE PADS, ETC, DETAILS BY TONY WALLACE STRUCTURAL ENGINEER.

FLOOR : [CARPET TILES ON] 75MM S/C SCREED, 500 GAUGE PLYTHENE SEPARATING LAYER, 100MM CELOTEX FR5120 INSULATION, 1200 GAUGE POLYTHENE DPM LAPPED INTO DPC IN WALL, BLOCK AND BEAM FLOOR SUPPORTED ON DWARF BRICK WALLS, VENTILATED AIR SPACE, 100MM CONCRETE OVERSITE SLAB. U = 0.14.

HEATING : EXISTING WOOD BURNING STOVE RELOCATED SET ON 50MM THICK STONE/CONCRETE BASE, STAINLESS STEEL FLUE THROUGH FLAT ROOF. + HOT WATER RADIATORS BENEATH WINDOWS FROM THE EXISTING BIO-MASS GENERATOR.

ELECTRICS : ELECTRICAL INSTALLATION TO BE CERTIFIED AS BEING IN ACCORDANCE WITH BS 7671 AND TO BE CARRIED OUT BY AN ACCREDITED ELECTRICIAN IN ACCORDANCE WITH PART P. ALL LOW ENERGY LIGHTING.

THERMAL INSULATION :

FLOOR AREA = 91.88 SM X 25% = 22.97
 OPENING AREA = 22.26 SM 22.36
 FLOOR AREA GREATER BY 0.61 SM

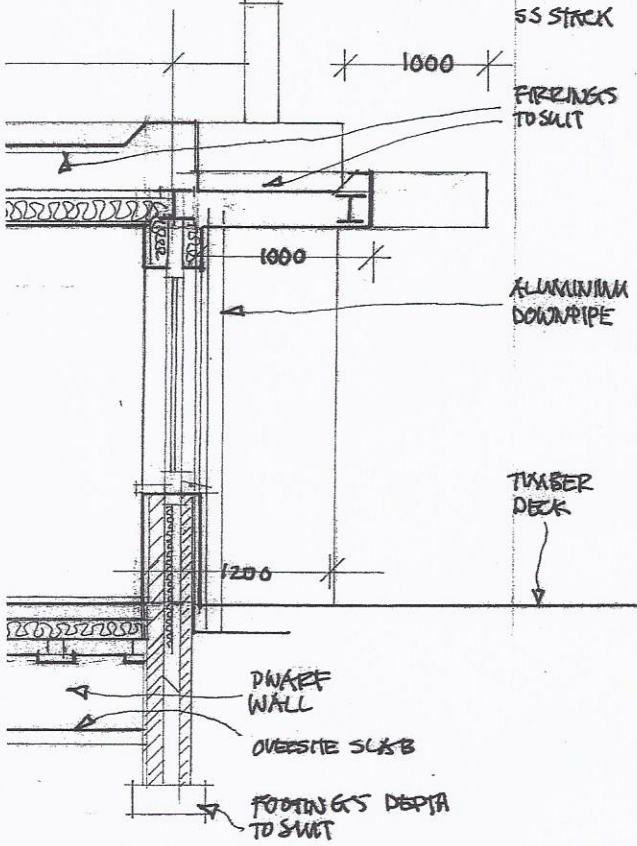

FUNCTION ROOM EXTENSION
 THE ROYAL LODGE HOTEL
 SYMONDS YAT EAST

**SECTIONS :
 PROPOSED**

1:50 @ A3 SEPT 15 5191:07

Geoff Jones : Architect
 53 Broad Street Ross-on-Wye
 Herefordshire HR9 7DY
 Phone & Fax 01989 769073